

NEW !
IP68 Protection

SPECIFICATIONS:

CONTACT RATING: Refer to "Contact Material Options" for more info.
 ELECTRICAL LIFE: Min. 50,000 make-and-break cycles at full load.
 CONTACT RESISTANCE: 10m-ohms max. initial @2-4VDC
 100mA for both silver and gold plated contacts.
 INSULATION RESISTANCE: 1,000M-ohms min.
 DIELECTRIC STRENGTH: 1,500VAC for 1 minute.
 OPERATING TEMPERATURE: -30°C to +85°C.

MATERIALS:

CASE: Diallyl phthalate(DAP)(UL 94V-0).
 PLUNGER: Brass, black finish with o-ring sealed.
 BUSHING: Brass, black finish with o-ring sealed.
 EXTERNAL SHELL: FR52 (UL 94V-0).
 TERMINAL SEAL: Epoxy.

If your preferred product configuration is not shown, please contact our sales representative for custom design.

HOW TO ORDER SYSTEM

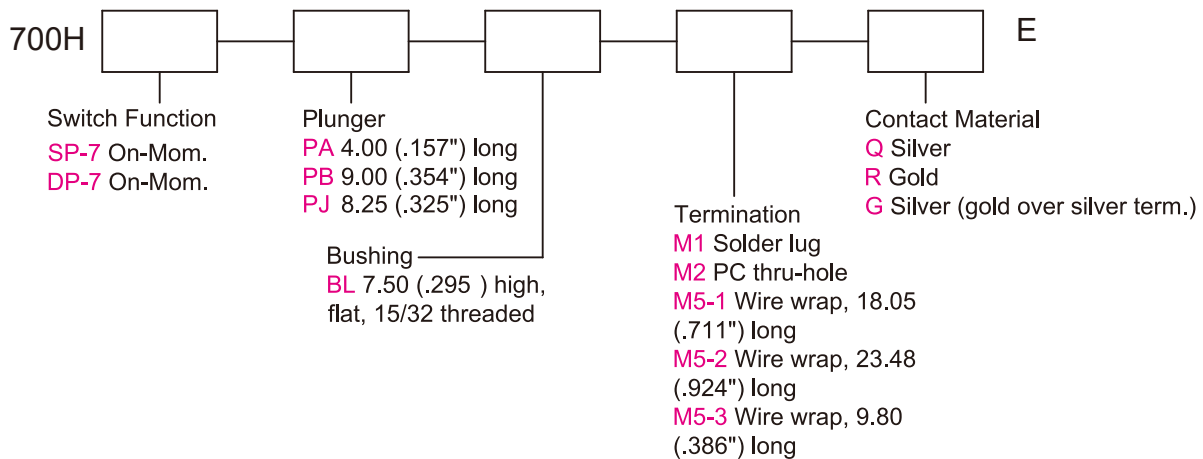
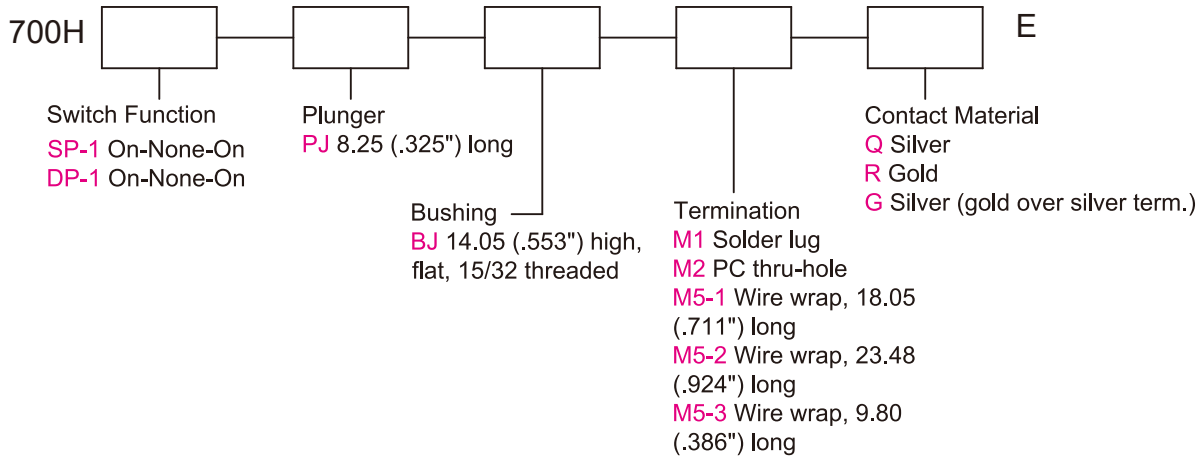

Series 700H

High Performance Sealed Pushbutton Switches

Toggle
Rocker
Slide
Pushbutton
AV
Rotary
Tact
Touch Key
Miscellaneous

SPDT



Model No.	Switching Position		
	SP-1	ON	NONE
Term. Comm.	2-3	OPEN	2-1

Schematic

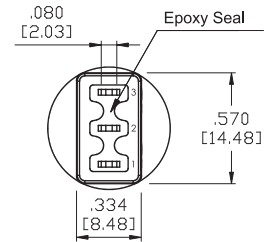
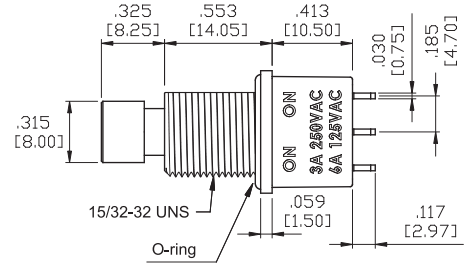
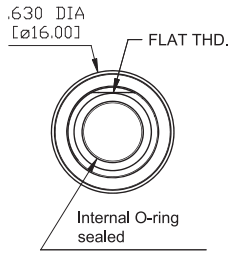

DPDT



Model No.	Switching Position		
	DP-1	ON	NONE
Term. Comm.	2-3,5-6	OPEN	2-1,5-4

Schematic

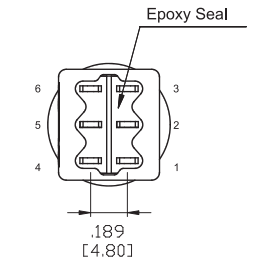
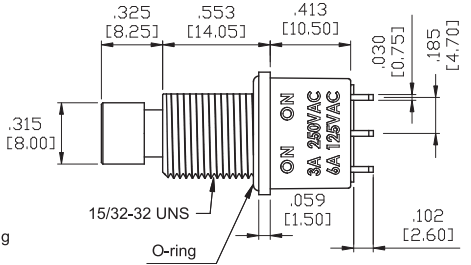
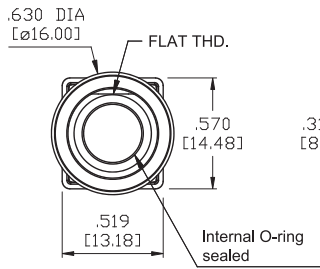
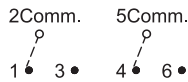

SPDT



Model No.	Switching Position	
	SP-7	ON
Term. Comm.	1-3	1-2

Schematic

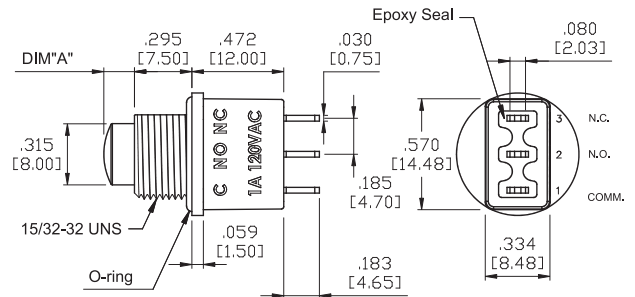
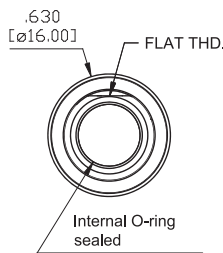

OPTION CODE	DIM. "A"
PA	.157 [4.00]
PB	.354 [9.00]

Series 700H

High Performance Sealed Pushbutton Switches

SPDT

Model No.	Switching Position	
SP-7	ON	MOM
Term. Comm.	1-3	1-2

Schematic



OPTION CODE	DIM. "A"
PJ	.325 [8.25]

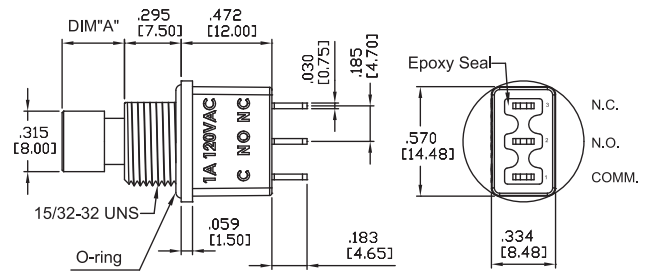
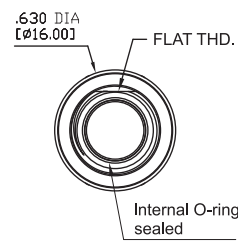

DPDT

Model No.	Switching Position	
DP-7	ON	MOM
Term. Comm.	1-3,4-6	1-2,4-5

Schematic

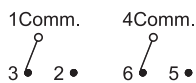

OPTION CODE	DIM. "A"
PA	.157 [4.00]
PB	.354 [9.00]

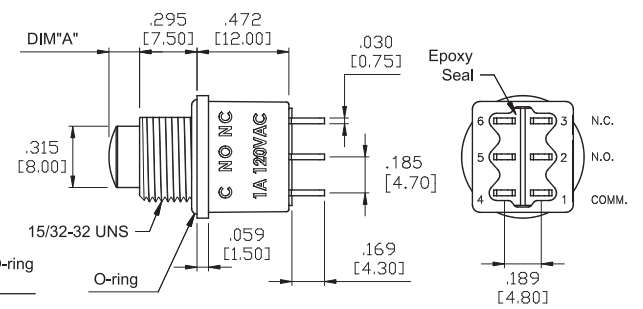
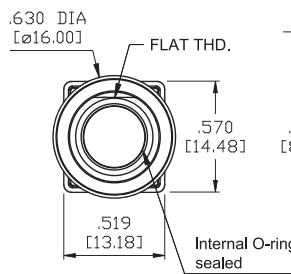

DPDT

Model No.	Switching Position	
DP-7	ON	MOM
Term. Comm.	1-3,4-6	1-2,4-5

Schematic

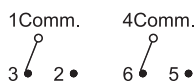

OPTION CODE	DIM. "A"
PJ	.325 [8.25]

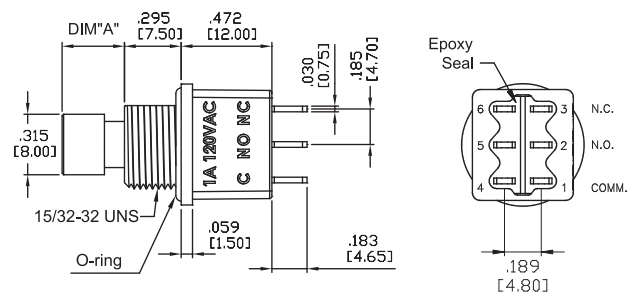
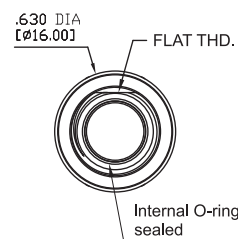

PANEL MOUNTING

15/32-32 UNS FLAT-CUT THD. BUSHING

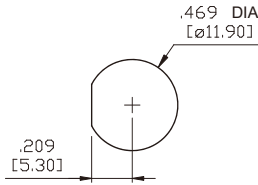

TERMINATION OPTIONS

M1 STD. SOLDER LUG

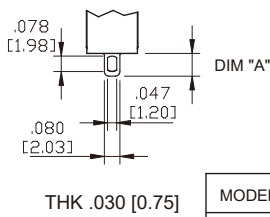

THK .030 [0.75]

MODEL	DIM "A"
DP-1	.116 [2.95]
DP-7	.183 [4.65]

M2 PC THRU-HOLE

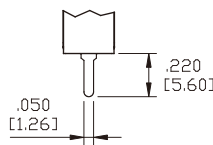

THK .030 [0.75]

M5 WIRE WRAP

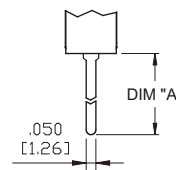

THK .030 [0.75]

OPTION CODE	DIM "A"
M5-1	.711 [18.05]
M5-2	.924 [23.48]
M5-3	.386 [9.80]

NUT

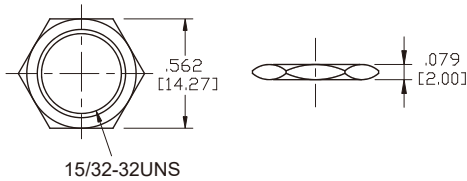

15/32-32UNS

LOCK WASHER

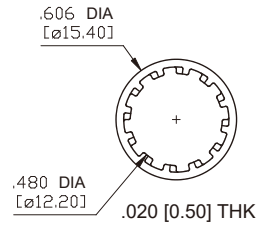

CONTACT MATERIAL OPTIONS

Coding	Contact Material	Terminal Plating	Rating	Agency Approvals
Q	Silver ¹	Silver plated ¹	(DP-1) 6Amps @ 125VAC or 28VDC 3Amps @ 250VAC (DP-7) 1Amps @ 120VAC or 38VDC	IP68
R	Gold ²	Gold plated ⁴	0.4VA max @ 20V max (AC or DC)	
G	Silver ¹	Gold over silver ³	(DP-1) 6Amps @ 125VAC or 28VDC 3Amps @ 250VAC (DP-7) 1Amps @ 120VAC or 38VDC	IP68

1. Movable Contact / Terminals: Copper alloy, silver plated.
2. Movable Contact: Copper alloy with gold plated over nickel plated.
3. Terminals: Silver plated with outer layer in gold plating.
4. Terminals: Copper alloy, with gold plated over nickel plated.