

SPECIFICATIONS:

CONTACT RATING: Refer to "Contact Material Options" for more info.

ELECTRICAL LIFE: 50,000 make-and-break cycles at full load.

CONTACT RESISTANCE: 10mΩ max. initial @ 2-4 VDC
100 mA for both silver and gold plated contacts.

INSULATION RESISTANCE: 1,000MΩ min.

DIELECTRIC STRENGTH: 1,500V RMS min. @ sea level.

OPERATING TEMPERATURE: -30°C to +85°C.

CAP INSTALLATION FORCE: 10 lbs, max.

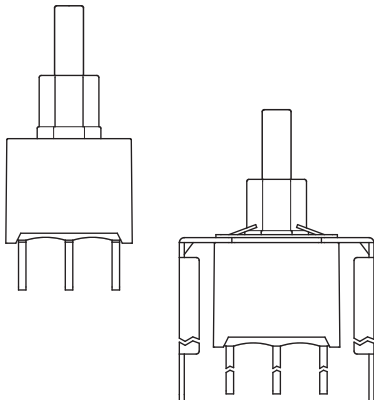

MATERIALS:

CASE & BUSHING: PA9T or FR52, flame retardant, heat stabilized (94V-0).

PLUNGER: Nylon 6/6 or PBT with internal o-ring sealed (700A).

PLUNGER: Nylon 6/6 or PBT (700C).

SWITCH SUPPORT: Brass or steel, tin plated.

SWITCH SUPPORT RETAINER: Stainless steel.

TERMINAL SEAL: Epoxy.

Specifications and Dimensions subject to change

If your preferred product configuration is not shown, please contact our sales representative for custom design.

HOW TO ORDER SYSTEM

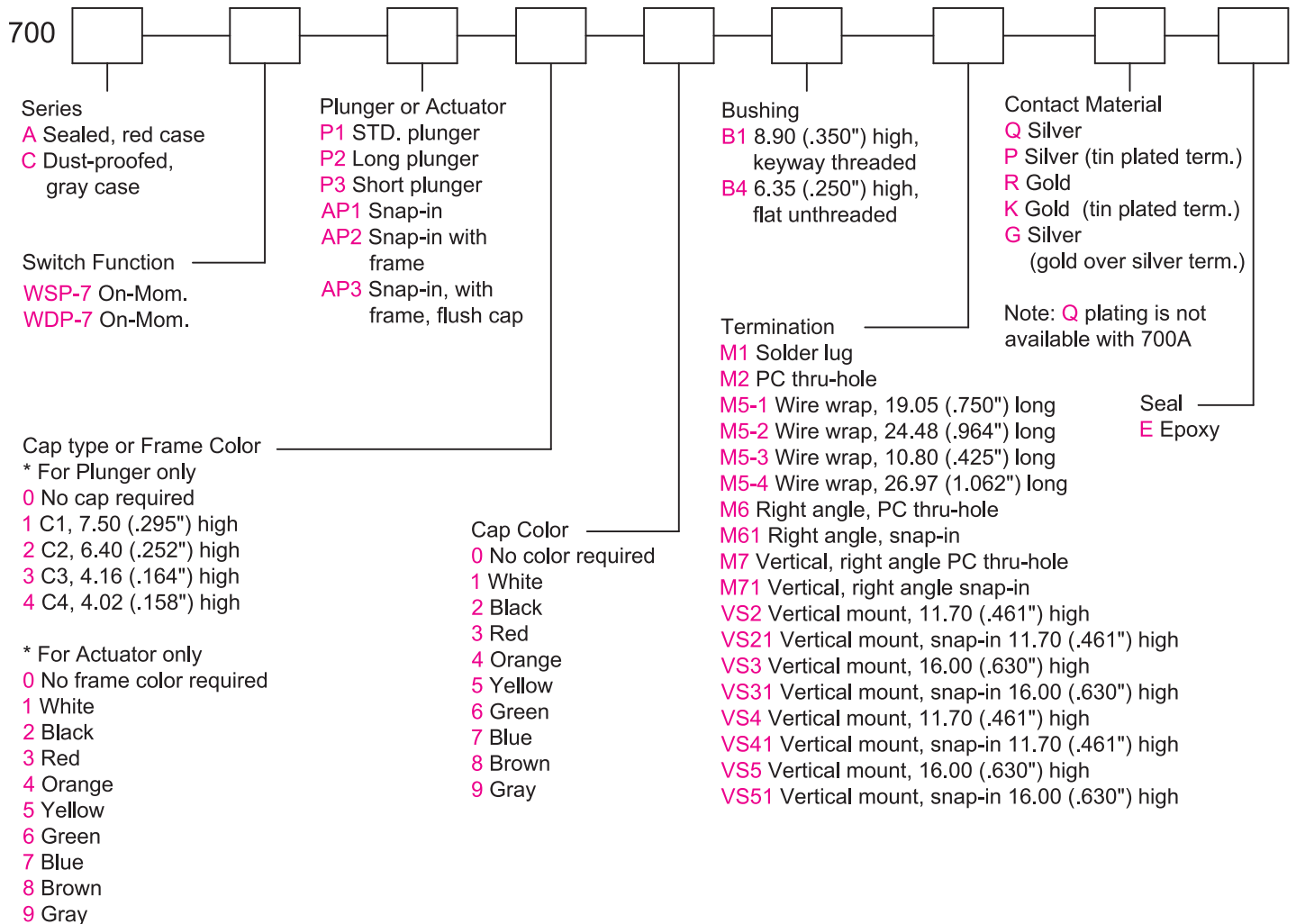

Series 700A/C

(Sealed) Snap-Acting Pushbutton Switches

SPDT



Model No.	Type	
WSP-7	ON	MOM
Term. Comm.	1-3	1-2

Schematic

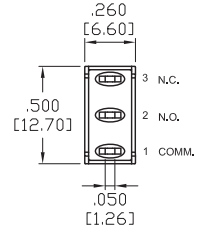
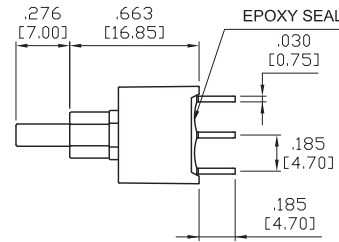
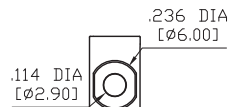

DPDT



Model No.	Type	
WDP-7	ON	MOM
Term. Comm.	1-3,4-6	1-2,4-5

Schematic

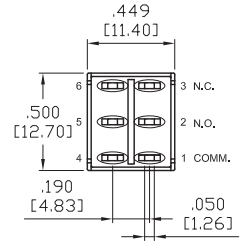
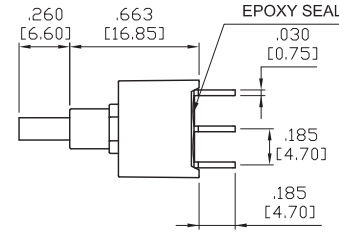
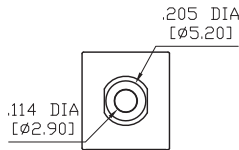
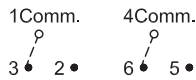

M6



SPDT

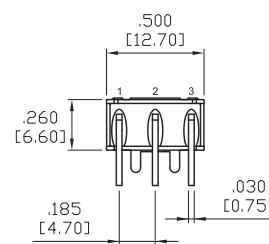
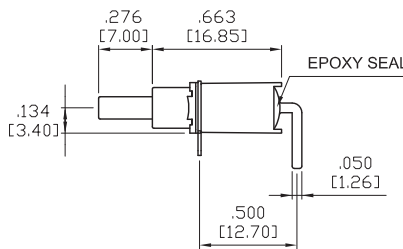
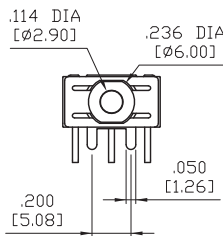

P.C.MOUNTING

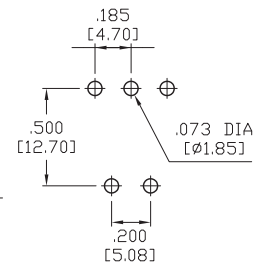

M6



DPDT

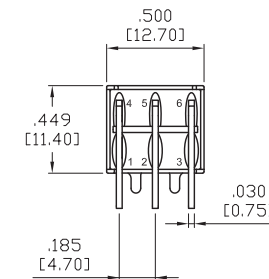
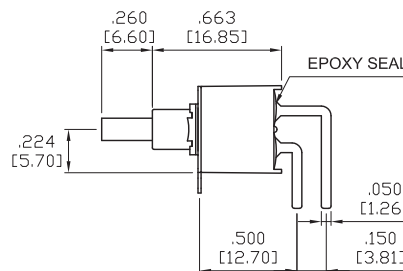
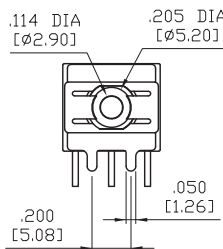

P.C.MOUNTING

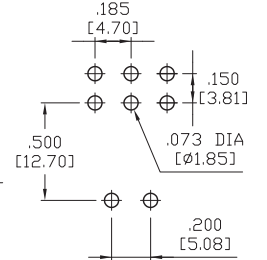

PLUNGER OPTIONS

FOR B1 BUSHING

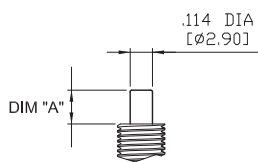

OPTION CODE	DIM. "A"
P1	.181 [4.60]
P2	.228 [5.80]
P3	.087 [2.20]

* Plunger length shown with SPDT model

FOR B4 BUSHING

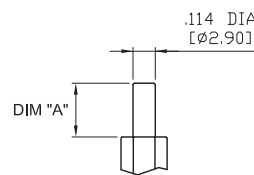

OPTION CODE	DIM. "A"
P1	.276 [7.00]
P2	.323 [8.20]
P3	.193 [4.90]

* Plunger length shown with SPDT model

BUSHING OPTIONS

B1

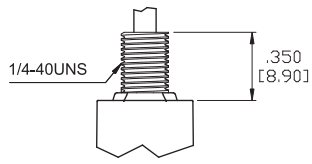

B4

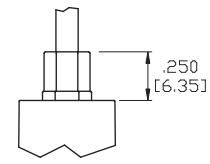

TERMINATION OPTIONS

M1

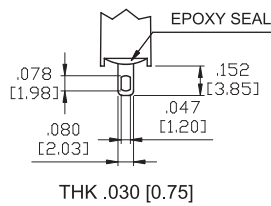

M2

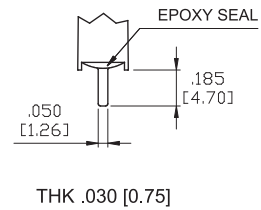

M7

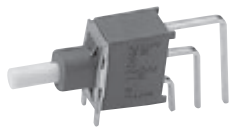

SPDT

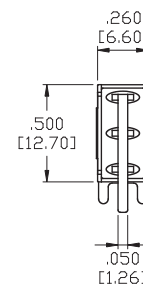
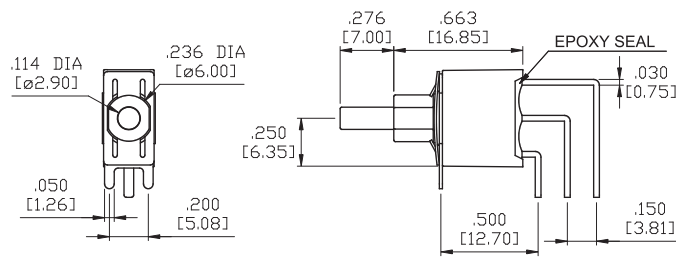

P.C.MOUNTING

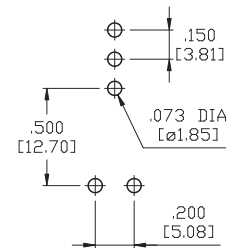

M7

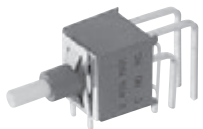

DPDT

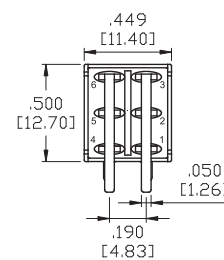
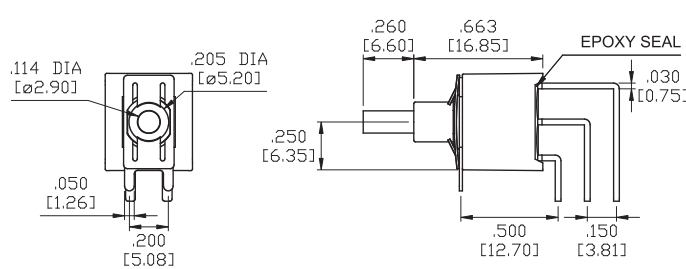

P.C.MOUNTING

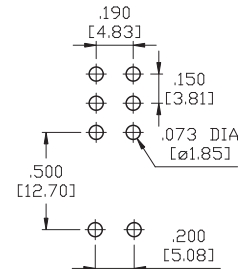

VS2-VS3

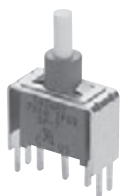

SPDT

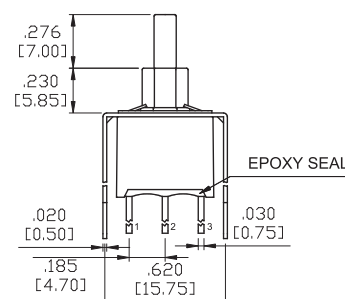
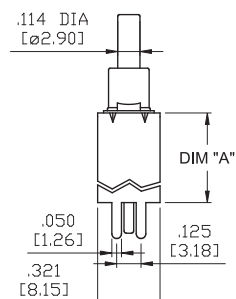

OPTION CODE	DIM.'A'
VS2	.461 [11.70]
VS3	.630 [16.00]

P.C.MOUNTING

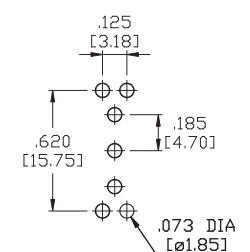

TERMINATION OPTIONS

VS2-VS3



DPDT

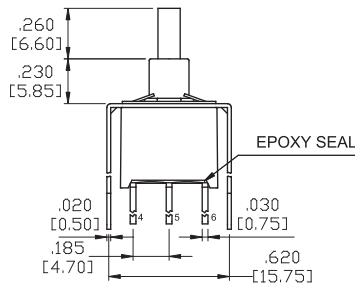
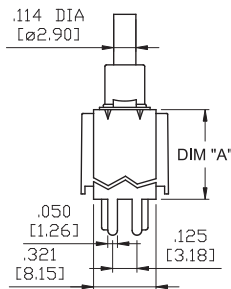

OPTION CODE	DIM.'A'
VS2	.461 [11.70]
VS3	.630 [16.00]

P.C.MOUNTING

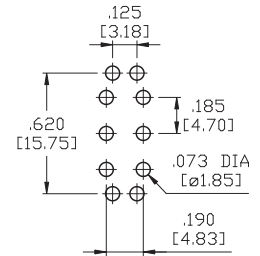

VS4-VS5

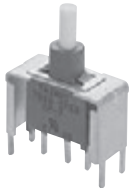

SPDT

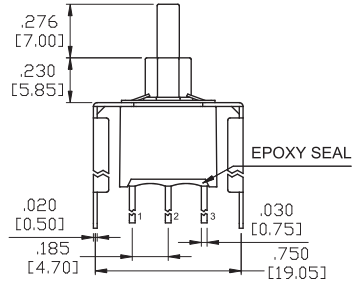
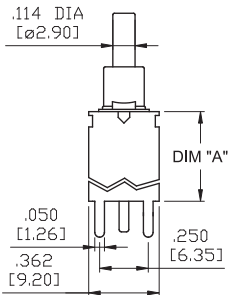

OPTION CODE	DIM.'A'
VS4	.461 [11.70]
VS5	.630 [16.00]

P.C.MOUNTING

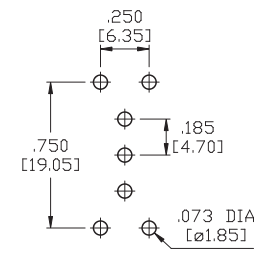

VS4-VS5



DPDT

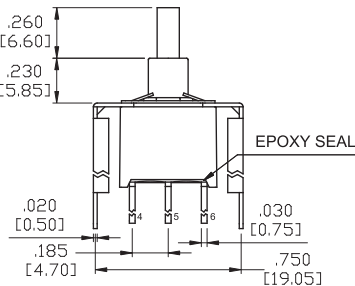
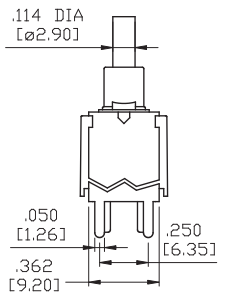

OPTION CODE	DIM.'A'
VS4	.461 [11.70]
VS5	.630 [16.00]

P.C.MOUNTING

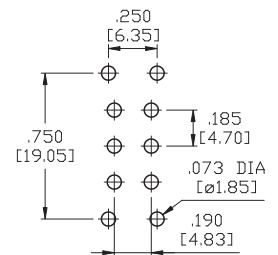

SNAP-IN TERMINATION OPTIONS

M61

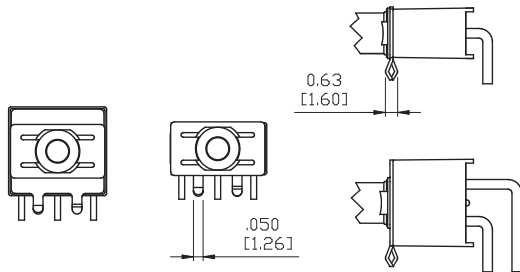

VS21,VS31

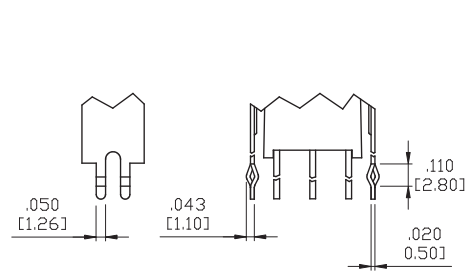

M71

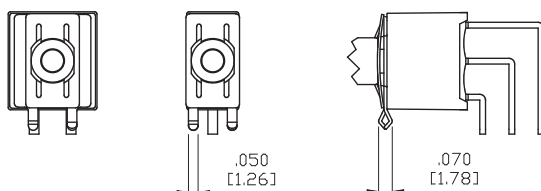

VS41,VS51

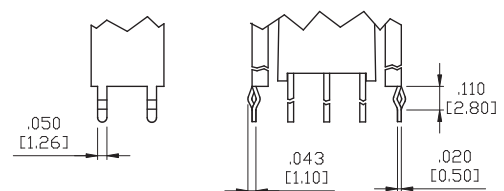

* PC Mounting for M61,M71,VS21,VS31,VS41,VS51 refer to M6,M7,VS2,VS3,VS4,VS5 respectively.

PLUNGER CAPS

C1	C2	C3	C4	CAP AND FRAME COLORS																				
<p>* MATERIAL: ABS.</p>	<p>* MATERIAL: ABS.</p>	<p>* MATERIAL: ABS.</p>	<p>* MATERIAL: ABS.</p>	<table border="1"> <thead> <tr> <th colspan="2">CAP AND FRAME COLORS</th> </tr> </thead> <tbody> <tr> <td>1</td> <td>White</td> </tr> <tr> <td>2</td> <td>Black</td> </tr> <tr> <td>3</td> <td>Red</td> </tr> <tr> <td>4</td> <td>Orange</td> </tr> <tr> <td>5</td> <td>Yellow</td> </tr> <tr> <td>6</td> <td>Green</td> </tr> <tr> <td>7</td> <td>Blue</td> </tr> <tr> <td>8</td> <td>Brown</td> </tr> <tr> <td>9</td> <td>Gray</td> </tr> </tbody> </table>	CAP AND FRAME COLORS		1	White	2	Black	3	Red	4	Orange	5	Yellow	6	Green	7	Blue	8	Brown	9	Gray
CAP AND FRAME COLORS																								
1	White																							
2	Black																							
3	Red																							
4	Orange																							
5	Yellow																							
6	Green																							
7	Blue																							
8	Brown																							
9	Gray																							

CONTACT MATERIAL OPTIONS

Coding	Contact Material	Terminal Plating	Rating	Agency Approvals
Q	Silver ¹	Silver plated ¹	1Amps @ 120VAC or 38VDC	IP68
R	Gold ²	Gold plated ³	0.4VA max @ 20V max (AC or DC)	IP68
G	Silver ¹	Gold over silver ⁴	1Amps @ 120VAC or 38VDC	IP68

* Standard G plating for sealed product.

1. Movable Contact / Terminals: Copper alloy, silver plated.
2. Movable Contact: Copper alloy with gold plated over nickel plated.
3. Terminals: Copper alloy, with gold plated over nickel plated.
4. Terminals: Silver plated with outer layer in gold plating.

* IP68 protection for 700A series only.