



SPECIFICATIONS:

CURRENT/VOLTAGE RATING WITH RESISTIVE LOAD:
 400mA 32VAC, 100mA 50VDC, 125mA 125VAC.(R18/R18L)
 100mA 24VDC, 2A 125VAC.(R18A/R18AL)
 CONTACT RESISTANCE: 50m-ohms max.
 INSULATION RESISTANCE: 1G-ohms Min.(500VDC)
 DIELECTRIC STRENGTH: 1,000VAC rms.
 ELECTRICAL LIFE AT FULL LOAD:
 500,000 cycles.(R18/R18L), 200,000 cycles.(R18A/R18AL)
 OPERATING TEMPERATURE: -30°C~85°C.
 TORQUE: 0.5Nm max. applied to nut.
 IP CLASS: IP67 front panel or full IP67.

MATERIALS:

CASE: Polyamide 6/6 or die-casting.
 CAP: Polyamide 6/6.
 BUSHING: Polyamide 6/6.

Specifications and Dimensions subject to change

If your preferred product configuration is not shown, please contact our sales representative for custom design.

HOW TO ORDER SYSTEM

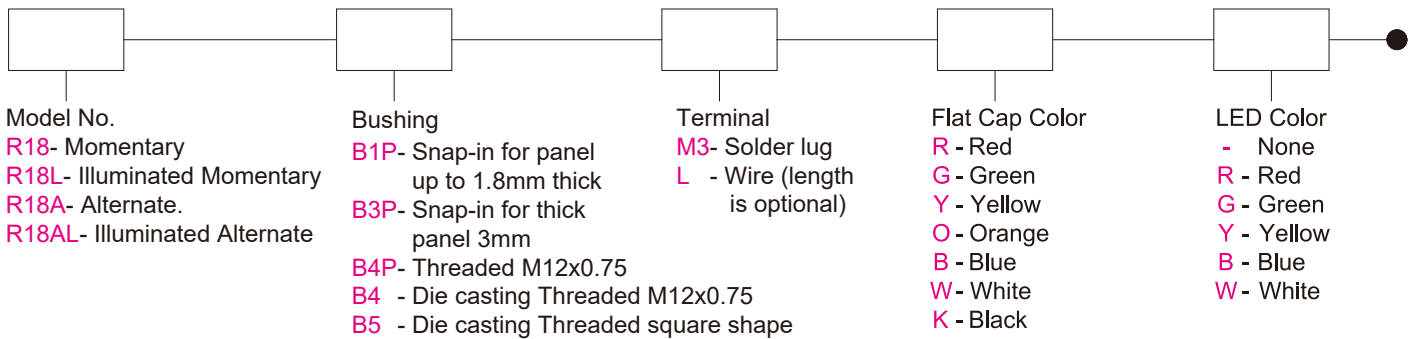

NOTES:

Alternate model is only available with B4P option.

Round Cap Color

R1- Red
G1- Green
Y1- Yellow
O1- Orange
B1- Blue
W1- White
K1- Black

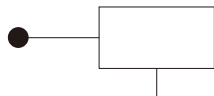

IP Code

- None (IP67 front panel)

IP67- Full IP67

SWITCH FUNCTIONS

Model No.	No. Poles	Switch Functions	
R18, R18L	SP	OFF	(ON)
R18A, R18AL	SP	OFF	ON

BUSHING OPTIONS

B1P

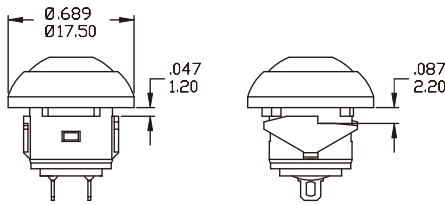

B3P

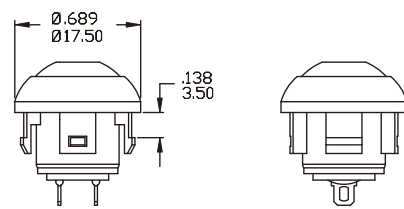

B4P / B4 for R18/R18L

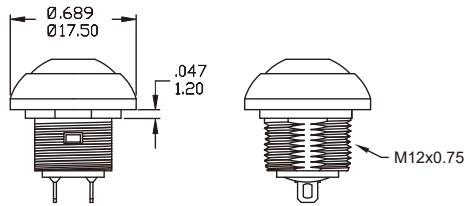

B4P for R18A/R18AL

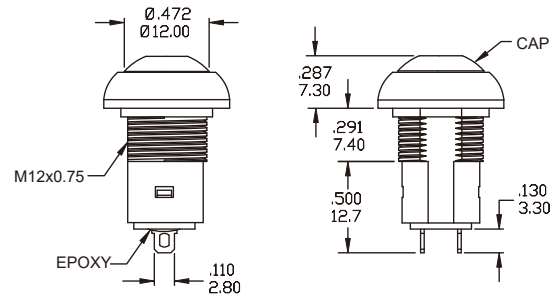

B5

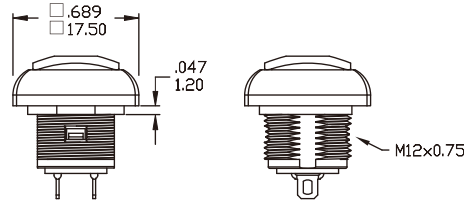

TERMINAL

M3 Solder lug

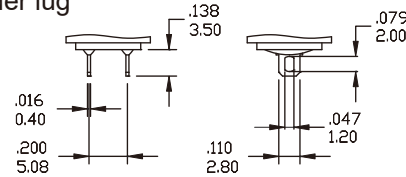

CAP OPTIONS

FLAT

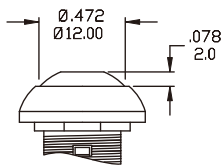

Code	Flat Cap Color
R	Red
G	Green
Y	Yellow
O	Orange
B	Blue
W	White
K	Black

ROUND

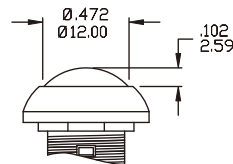

*Only for B1P, B3P, B4P, B4 bushing type

Code	Round Cap Color
R1	Red
G1	Green
Y1	Yellow
O1	Orange
B1	Blue
W1	White
K1	Black

LED COLOR

Code	LED Color	Code	LED Color
R	Red	B	Blue
G	Green	W	White
Y	Yellow		