

SPECIFICATIONS:

CONTACT RATING: 50mA 12V DC.
 CONTACT RESISTANCE: 100m-ohms max. at 1A 2-4VDC.
 INSULATION RESISTANCE: 100M-ohms max. @ 500VDC.
 WITHSTAND VOLTAGE: 100VAC RMS for 1 min.
 ENDURANCE: 10,000 cycles @ 10 cpm.

TOTAL TRAVEL: 0.25mm.

Specifications and Dimensions subject to change

KRS-0312

P.C.B. LAND PATTERN



L	DIM. "A"
1	.169 [4.30]
2	.197 [5.00]

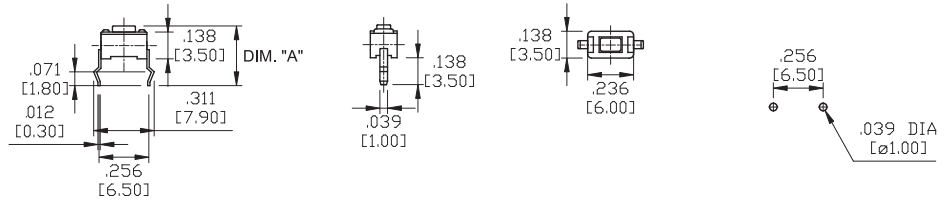

KRS-0314

P.C.B. LAND PATTERN



L	DIM. "A"
1	.124 [3.15]
2	.152 [3.85]

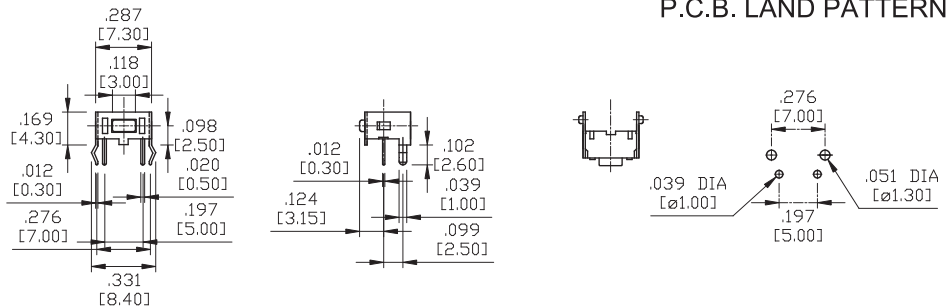

KRS-0315

P.C.B. LAND PATTERN



L	DIM. "A"
1	.169 [4.30]
2	.197 [5.00]

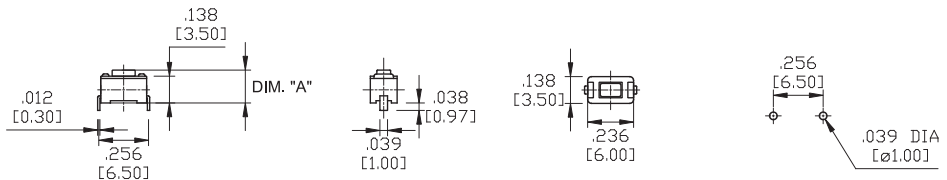

KRS-0316

P.C.B. LAND PATTERN



L	DIM. "A"
1	.169 [4.30]
2	.197 [5.00]

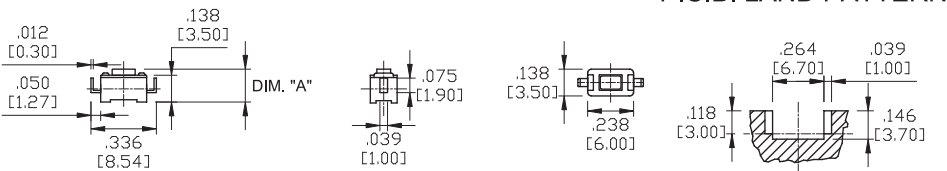

KRS-0612

P.C.B. LAND PATTERN



L	DIM. "A"
1	.169 [4.30]
2	.197 [5.00]
3	.276 [7.00]
5	.374 [9.50]
6	.512 [13.00]
7	.531 [13.50]
8	.315 [8.00]

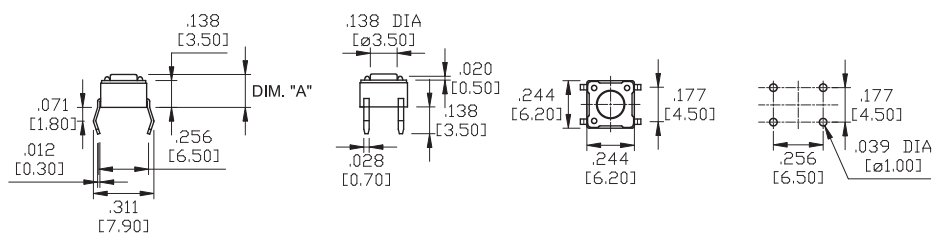

Series KRS

Tact Switches/Tactile Switch SMT

KRS-0613

P.C.B LAND PATTERN



L	DIM. "A"
1	.169 [4.30]
2	.197 [5.00]
3	.276 [7.00]
5	.374 [9.50]

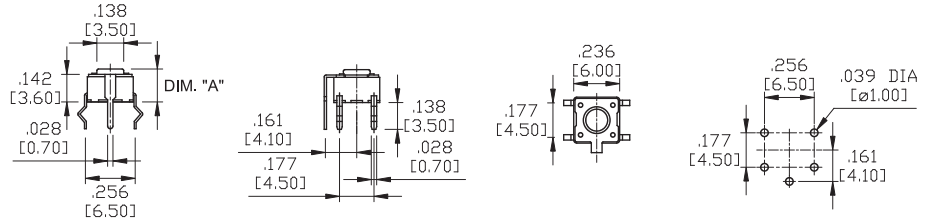

KRS-0614

P.C.B LAND PATTERN



L	DIM. "A"
1	.124 [3.15]
2	.152 [3.85]
3	.230 [5.85]
5	.329 [8.35]
6	.467 [11.85]

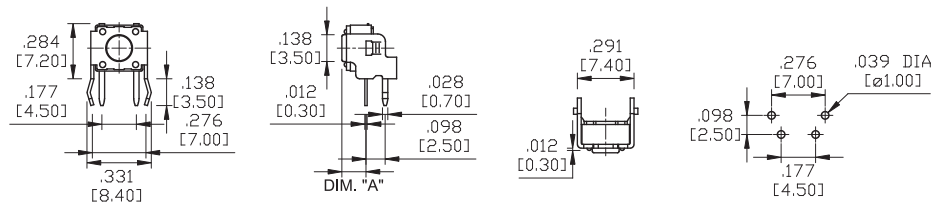

KRS-0615

P.C.B LAND PATTERN

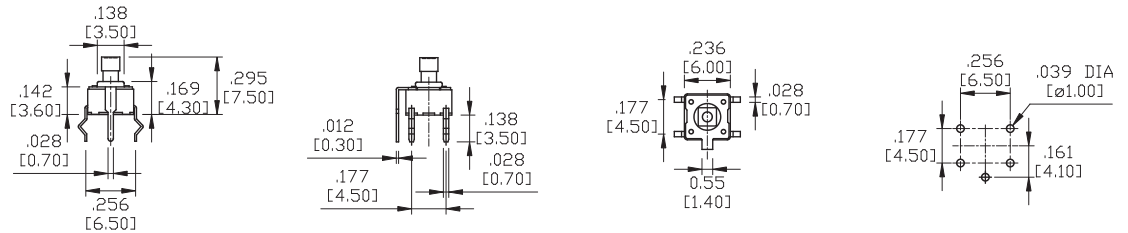

KRS-1213

P.C.B LAND PATTERN

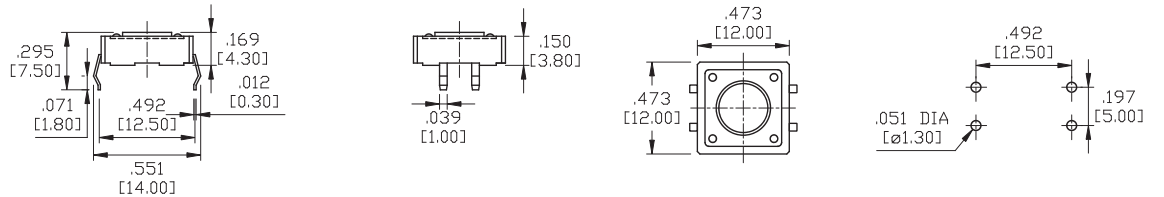
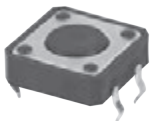

KRS-1223

P.C.B LAND PATTERN

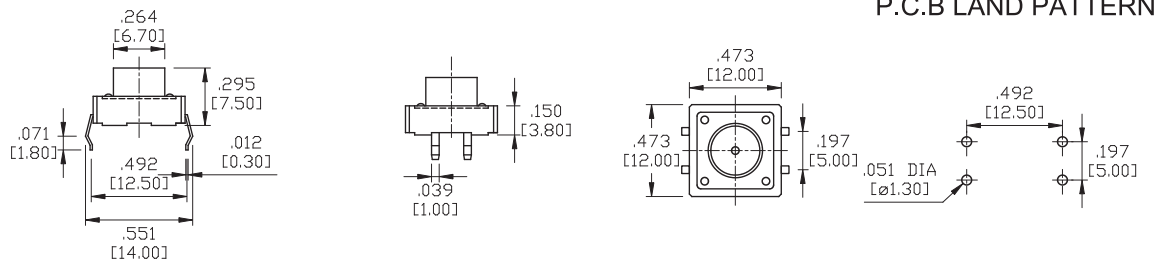

KRS-1243

P.C.B LAND PATTERN

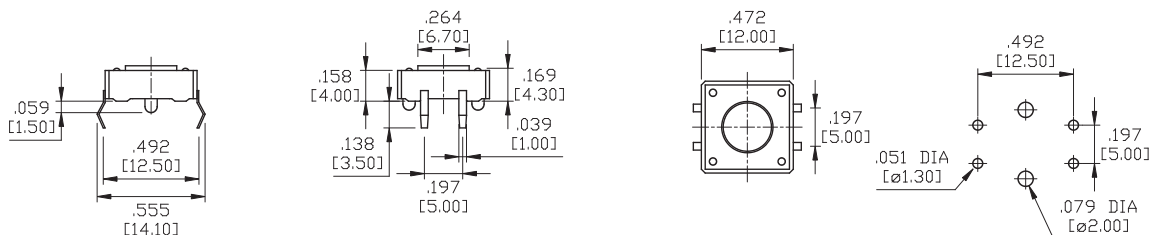

Toggle

Rocker

Slide

Pushbutton

AV

Rotary

Tact

Touch Key

Miscellaneous

Series KRS

Tact Switches/Tactile Switch SMT

KRS-1263

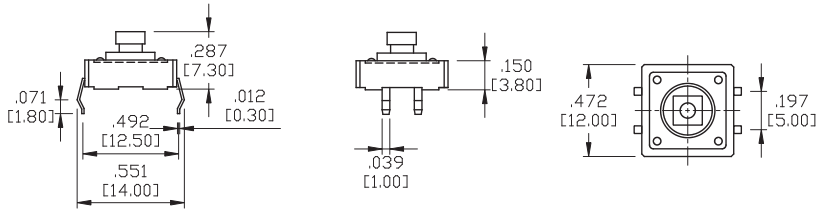
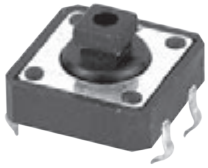

P.C.B LAND PATTERN

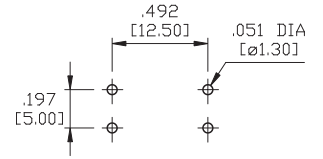

KRS-1273

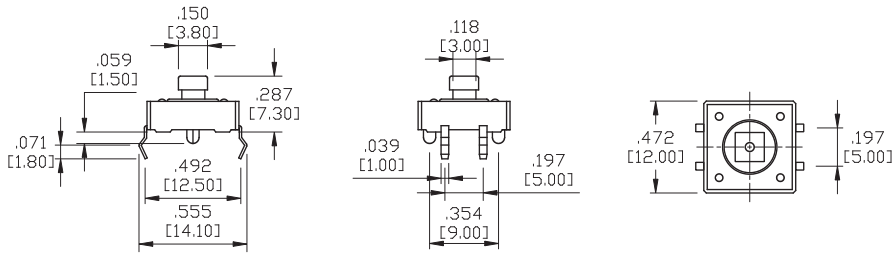

P.C.B LAND PATTERN

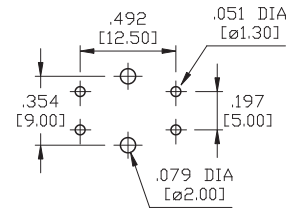

KRS-1283

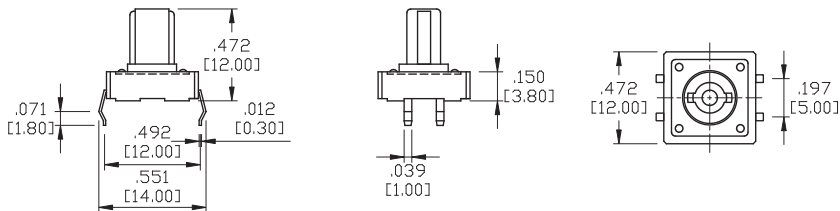

P.C.B LAND PATTERN

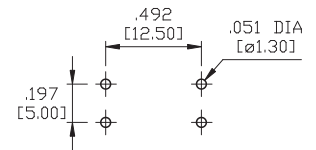

KRSM-3A



L	DIM. "A"
1	.169 [4.30]
2	.197 [5.00]

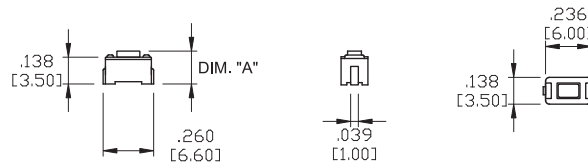

P.C.B LAND PATTERN

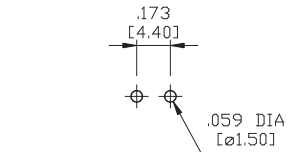

KRSM-3B



L	DIM. "A"
1	.169 [4.30]
2	.197 [5.00]

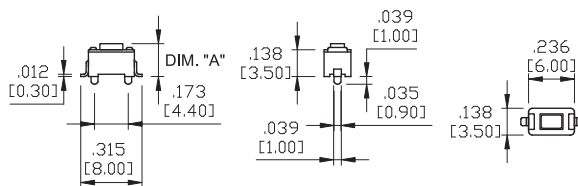

P.C.B LAND PATTERN

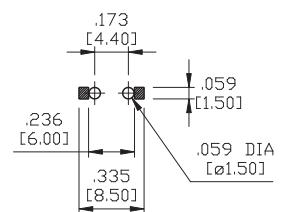

KRSM-3C



L	DIM. "A"
1	.169 [4.30]
2	.197 [5.00]

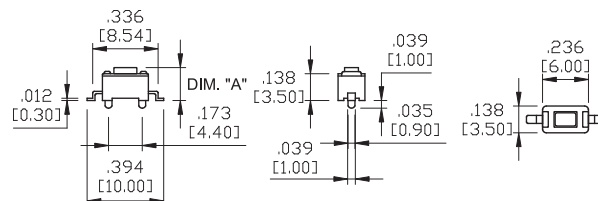

P.C.B LAND PATTERN

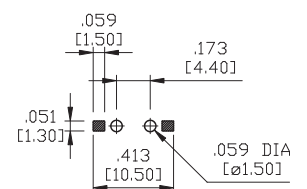

Series KRS

Tact Switches/Tactile Switch SMT

KRSM-6

P.C.B LAND PATTERN



L	DIM. "A"
1	.169 [4.30]
2	.197 [5.00]
3	.276 [7.00]
4	.287 [7.30]
5	.374 [9.50]

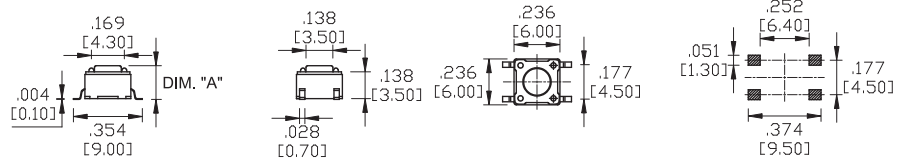

KRSM-13

P.C.B LAND PATTERN

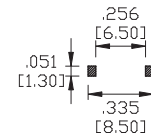
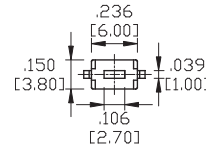
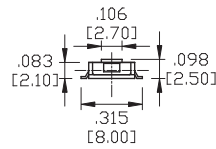

KRSM-16 □ □

P.C.B LAND PATTERN

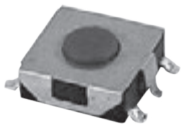

MODEL NO.	DIM."A"	DIM."B"	DIM."C"
KRSM-1611	.315 [8.00]	.098 [2.50]	.394 [10.00]
KRSM-1612	.315 [8.00]	.122 [3.10]	.394 [10.00]
KRSM-1621	.394 [10.00]	.098 [2.50]	.472 [12.00]
KRSM-1622	.394 [10.00]	.122 [3.10]	.472 [12.00]

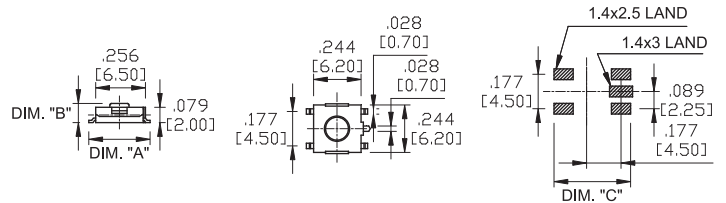

CAP

CAP COLORS

For KRS-1263 and KRS-1273 only

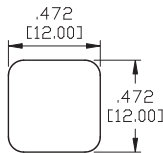

Color No.	Color	Color No.	Color
1	White	6	Green
2	Black	7	Blue
3	Red	8	Brown
4	Orange	9	Gray
5	Yellow		

HOW TO ORDER

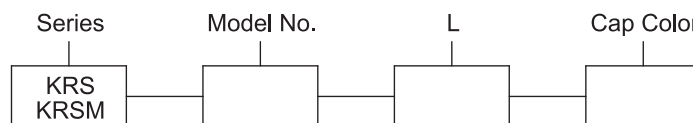

* Cap color only required when cap is ordered.

Toggle

Rocker

Slide

Pushbutton

AV

Rotary

Tact

Touch Key

Miscellaneous

SPECIFICATIONS:

RATING: 12 VDC 50 mA.
 OPERATING TEMPERATURE: -20°C +70°C.
 CONTACT RESISTANCE: 100m-ohms (initial).
 INSULATION RESISTANCE: 50M-ohms DC100V Min.
 OUTPUT RESOLUTION:
 10 pulse / 360°, each detent 36°±3°.

CENTER PUSH TRAVEL:
 3SA: 1st=3.1±0.15mm, 2nd=2.9±0.15mm.
 3SC: 3.35±0.1mm.
 OPERATING FORCE (CENTER PUSH):
 1st=100±50gf, 2nd=260±80gf,
 rotary=80gf-cm±50gf-cm.
 ELECTRICAL LIFE (CENTER PUSH):
 center push:100,000 cycles Min.
 rotary:50,000 cycles Min.

Specifications and Dimensions subject to change

3SA

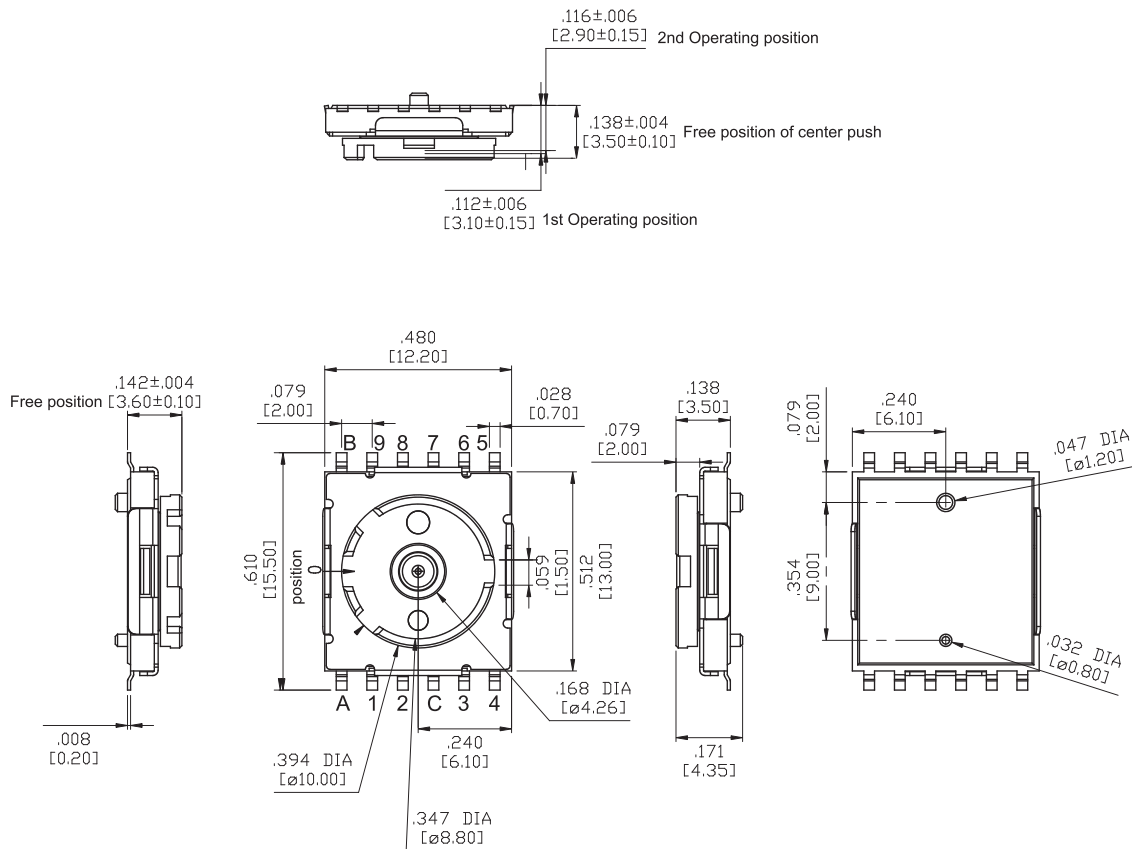

CODE: A (10 position)

POSITION	0	1	2	3	4	5	6	7	8	9
TERMINAL C		●	●	●	●	●	●	●	●	●
1		●								
2			●							
3				●						
4					●					
5						●				
6							●			
7								●		
8									●	
9										●

The ● marks shows the "ON" position.

CIRCUIT DIAGRAM OF CENTER PUSH

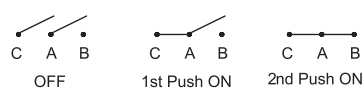

P.C.B MOUNTING

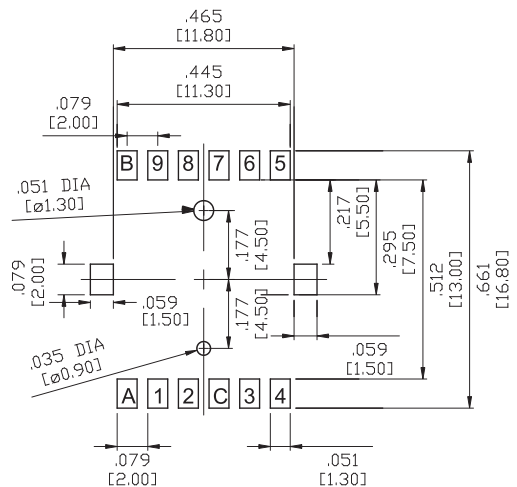

3SC

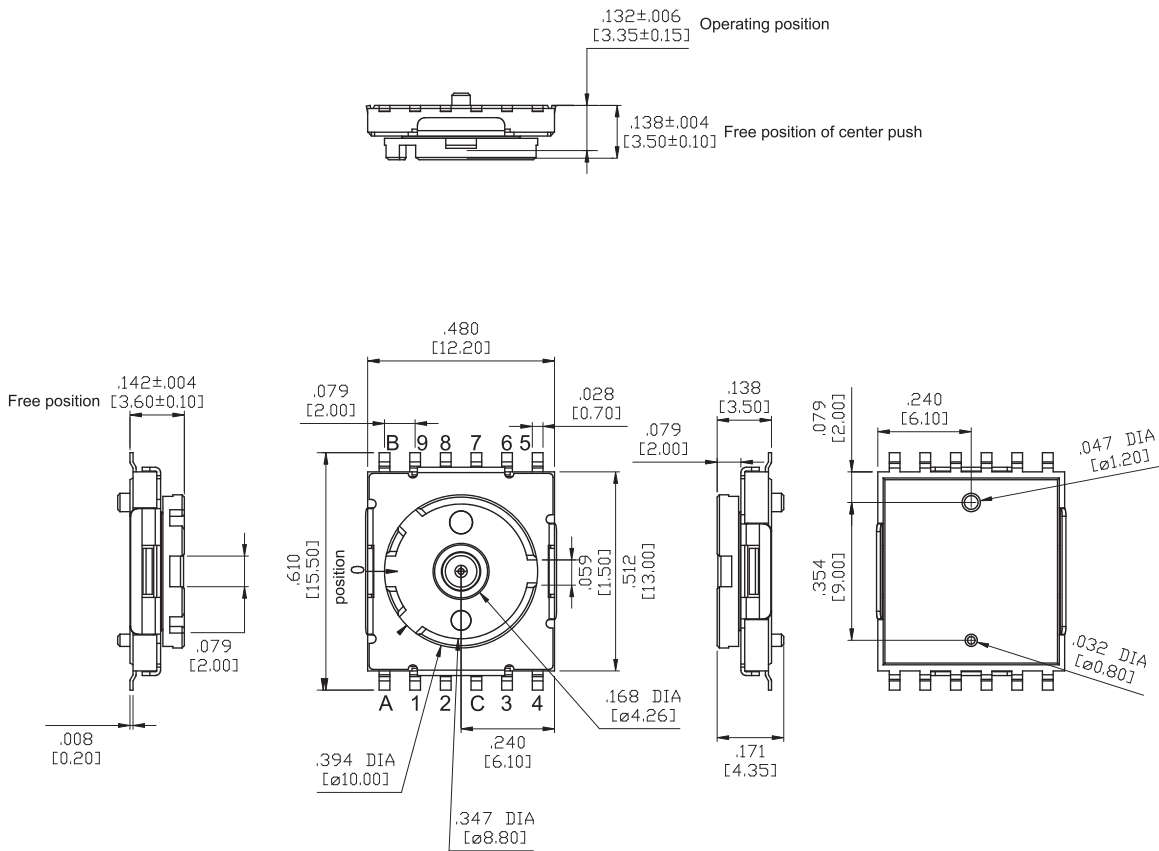

CODE: C (10 position)
 CIRCUIT DIAGRAM OF ROTARY

POSITION	0	1	2	3	4	5	6	7	8	9
C		●	●	●	●	●	●	●	●	●
1		●								
2			●							
3				●						
4					●					
5						●				
6							●			
7								●		
8									●	
9										●

The ● marks shows the "ON" position.

CIRCUIT DIAGRAM OF CENTER PUSH



P.C.B MOUNTING

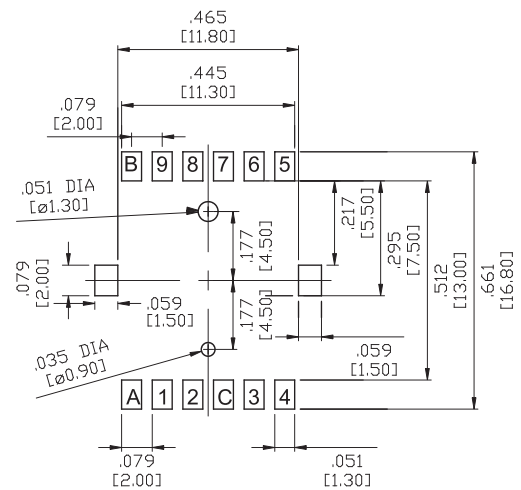

HOW TO ORDER

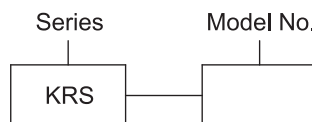

Toggle

Rocker

Slide

Pushbutton

AV

Rotary

Tact

Touch Key

Miscellaneous